

FORGED STEEL (A 105) GLOBE VALVE CLASS-800 (REDUCED BORE)

Specification & Features:

Conforming To BS : 5352 / API 602 BSEN - 15761
Screwed female ends to BSP / NPT / Socket Welded Ends To ANSI B 16.11
Bolted bonnet, outside screw, yoke type, rising stem
Sturdy in design & superb in quality.
Handwheel operated.



ITEM CODE # FS - 302

Pressure / Temperature ratings

| | | | | | | | | | | | | | | |
|-------------------------|--------------|-------|------|------|------|------|------|------|------|------|-----------|-----------|-----------|-----------|
| Temperature °Celsius | -29° +38° | 93.5° | 149° | 204° | 260° | 316° | 343° | 371° | 399° | 427° | * 454° | * 482° | * 510° | * 538° |
| Pressure bar | 136 | 124 | 121 | 117 | 110 | 101 | 99 | 98 | 93 | 76 | 49 | 32 | 19 | 10 |

* Permissible but not recommended for prolonged usage above 427° celsius

Materials of Construction

| NAME OF PART | MATERIAL | STANDARD |
|-----------------------------|--|-----------------------|
| Body, Gland Flange & Bonnet | Forged Steel | ASTMA 105 |
| Body Ring, Disc | Stainless Steel | ASTM 276 Type 410 |
| Stem, Gland Bush | Stainless Steel | ASTM 276 Type 410 |
| Fastners | Alloy Steel | ASTM 193 B7 / A194 2H |
| Gasket | Spiral Wound S.S. 304 Graphite Filled | |
| Packing | Braided Graphite Yarn Containing Corrosion Inhibitor To Suit 400°C | |
| Hand Wheel | S.G. Iron | DIN 1693 GGG40 |

Sizes / Dimensions

| Sizes | | Dimensions | | | |
|--------|----|------------|-------|-----|-----|
| Inches | mm | A | B | C | DØ |
| 1/2 | 15 | 80 | 1/2 | 140 | 80 |
| 3/4 | 20 | 88 | 3/4 | 150 | 80 |
| 1 | 25 | 100 | 1 | 170 | 90 |
| 1-1/2 | 40 | 145 | 1-1/2 | 240 | 152 |
| 2 | 50 | 170 | 2 | 275 | 152 |

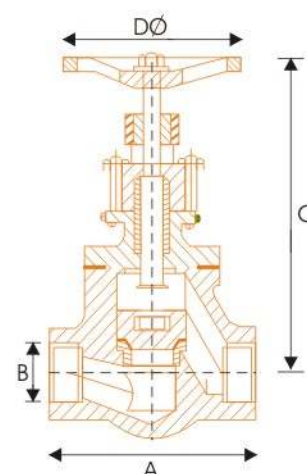

B.V.M. MANUFACTURERS & EXPORTERS

