

FORGED STEEL (A 105) GATE VALVE CLASS-800 (REDUCED BORE)

Specification & Features:

Conforming To BS : 5352 / API 602 BSEN - 15761
Screwed female ends to BSP / NPT / Socket Welded Ends To ANSI B 16.11
Bolted bonnet, outside screw, yoke type, rising stem
Handwheel Operated, Sturdy in design & superb in quality.

Pressure / Temperature ratings

Temperature °Celsius	-29° +38°	93.5°	149°	204°	260°	316°	343°	371°	399°	427°	* 454°	* 482°	* 510°	* 538°
Pressure bar	136	124	121	117	110	101	99	98	93	76	49	32	19	10

* Permissible but not recommended for prolonged usage above 427° celsius



ITEM CODE # FS - 301

Materials of Construction

NAME OF PART	MATERIAL	STANDARD
Body, Gland Flange & Bonnet	Forged Steel	ASTMA 105
Body Ring, Wedge	Stainless Steel	ASTM 276 Type 410
Stem, Gland Bush	Stainless Steel	ASTM 276 Type 410
Fastners	Alloy Steel	ASTM 193 B7 / A194 2H
Gasket	Spiral Wound S.S. 304 Graphite Filled	
Packing	Braided Graphite Yarn Containing Corrosion Inhibitor To Suit 400°C	
Hand Wheel	S.G. Iron	DIN 1693 GGG40

Sizes / Dimensions

Sizes		Dimensions			
Inches	mm	A	B	C	DØ
1/2	15	80	1/2	132	80
3/4	20	88	3/4	142	80
1	25	100	1	165	90
1-1/2	40	145	1-1/2	220	152
2	50	170	2	240	152

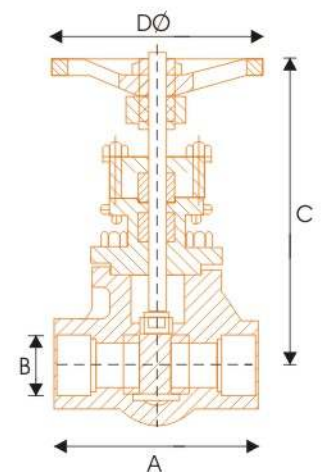

B.V.M. MANUFACTURERS & EXPORTERS

